

1.MATERIALS: COMPLANT ROHS STANDARD.  
 CONTACTS: BRASS,C2680 T=0.20mm.  
 SHELL: SPCC T=0.35.  
 BOAR LOCK: SPCC T=0.60mm.  
 RIVET: BRASS  
 SCREW: STEEL  
 HOUSING AND COVER: PBT,PANTONE BLACK,UL94V-0 RATED.  
 BRACKET: PA66,PANTONE BLACK,UL94V-0 RATED.

2.PLATING:  
 CONTACT: GOLD FLASH ON THE CONTACT AREA,  
 PLATED TIN 120u" ON THE SOLDER TAILS,  
 PLATED NICKEL 30u" UNDER ALLOVER.  
 SHELL: PLATED NICKEL 120u" Min,PLATED Cu 80u" ALLOVER.  
 BOARD LOCK: PLATED TIN 120u" ABOVE;PLATED NICKEL 100u" Min,  
 PLATED Cu 100u"MIN. ALLOVER.  
 RIVET: PLATED 100u" Ni ALL  
 SCREW: PLATED NICKEL 120u" Min. PLATED Cu 80u" ALLOVER.

3.ELECTRICAL CHARACTERISTICS:  
 CONTACT CURRENT RATING:2 AMP.  
 DIELECTRIC WITHSTANDING VOLTAGE:AC 500V.  
 INSULATION RESISTANCE:1000 MEGAOHMS MIN.AT DC 500V  
 CONTACT RESISTANCE:30 MILLIOHMS MAX.

4.ENVIRONMENTAL:TEMPERATURE RANGE -20°C TO +85°C

5.MECHANICAL:  
 MATING FORCE:4.5 KGF(INITIAL).  
 UNMATING FORCE:3.5 KGF(INITIAL).  
 CONTACT RETENTION TO HOUSING:0.5 KGF(MIN);  
 DURABILITY:1000MATING CYCLES  
 ENDURANT TWISTING FORCE OF THE SCREW:5.5 KGF-CM MAX.

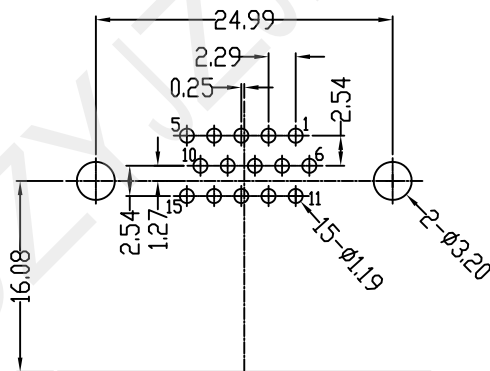
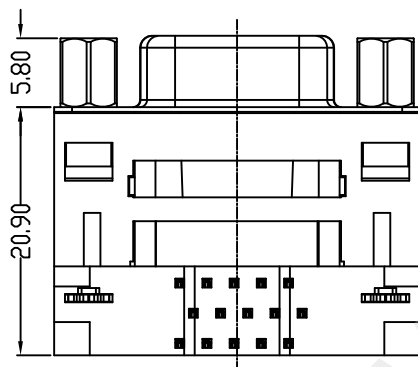

RECOMMENED PCB LAYOUT  
 TOP VIEW (TOLERANCE:±0.05)



# 深圳市华宇创精密电子有限公司

TOLERANCE: X.X ±0.30 X.XX ±0.25 X.XXX ±0.15 X' ±2' X.X' ±0.5'	DRAWN BY : 陈一鸣	DATE : 2014-02-23	PART NAME: HDR15母 架高 塑胶支架 横叉 铆锁
	CHECKED BY: 马跃	DATE : 2014-02-23	PART NO. HYC259-VGA15B-316
UNIT: mm [inch] SCALE:1:1 SIZE: A4	APPROVED BY: 邱敏	DATE : 2014-02-23	MOLD NO.
			DRAW NO: HYC-2606111445
			SHEET NO. 1 OF 1